

# JVC

## LT-Z32FX6 LT-Z40SX6

WIDE LCD PANEL TV INSTRUCTIONS

# JVC



LT-Z32FX6

**DynaPiX HD**  
Powered by D.L.S.

**HDMI™**  
HIGH-DEFINITION MULTIMEDIA INTERFACE

**MaxxBass®**



LT-Z40SX6

**1**

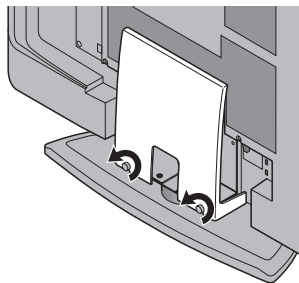

**2**

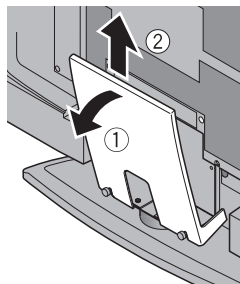

**3**

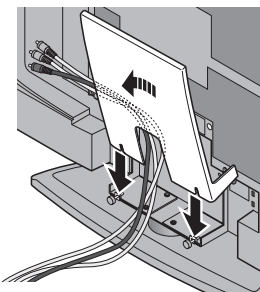

**4**

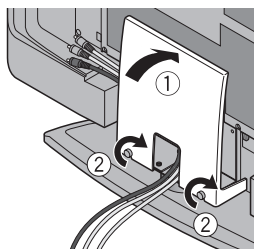

LT-Z32FX6

**1**

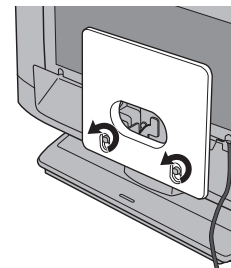

**2**

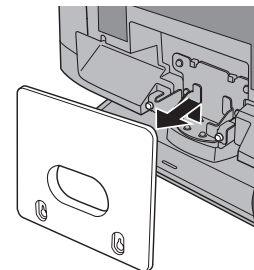

**3**

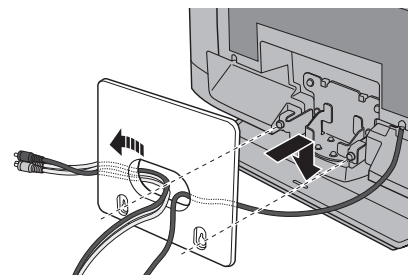

**4**

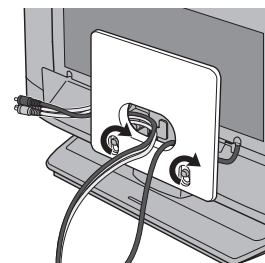

# Expanding the world of beautiful images

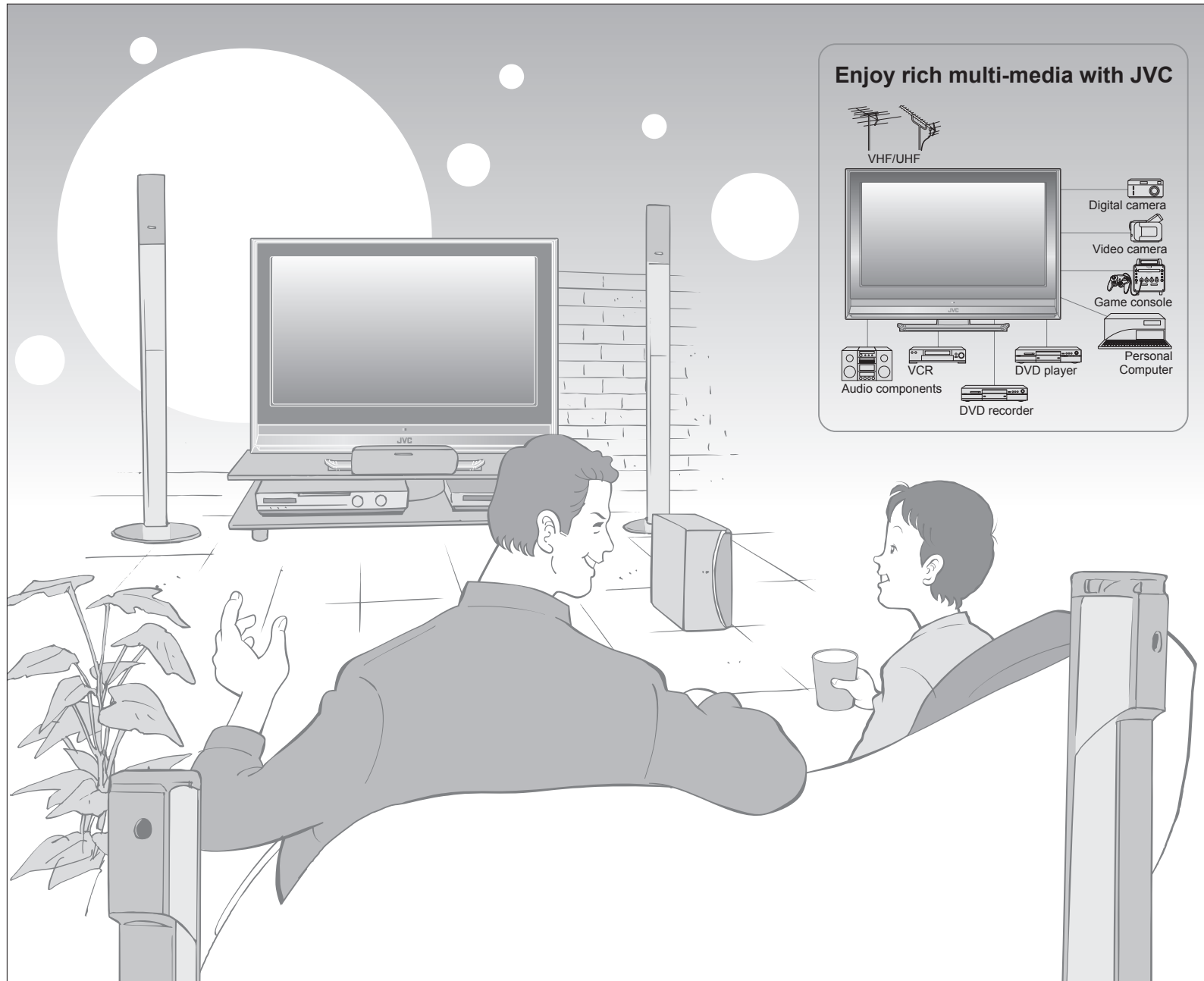

## Enjoy rich multi-media with JVC

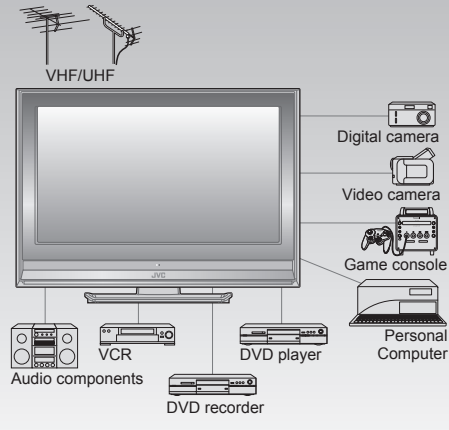

## Contents

### First things first!

- Warning ..... 3

### Getting started

- Names of all the parts ..... 5
- Basic connections ..... 7
- Initial settings ..... 9
- Editing channels ..... 11
  - Registering channels
- Connecting external devices ..... 13

### Let's try it out

- Enjoying your new TV! ..... 15
  - TV / Teletext / Video / etc.
- Watching TV ..... 17
- Viewing teletext ..... 19
- Watching videos / DVDs ..... 21

### Try the advanced features

- Useful functions ..... 23
  - Take a snapshot
  - View and search in multi-picture mode
  - "Sleep Timer" / "Channel Guard"
- Operate JVC recorders and other devices ..... 27

### Just the way you like it

- Customising your TV ..... 29
- Advanced picture adjustment ..... 31
  - Reduce noise / Watch a more natural picture
  - Set the aspect ratio, etc.

### When you have trouble

- Troubleshooting ..... 33
- Technical information ..... 37
- "CH/CC" List ..... 39
- Specifications ..... 40

# Warning

Please follow all the guidelines below

ENGLISH

## Follow this manual regarding setup!

- Connect only to a 110-240V, 50/60Hz AC outlet.

## Do not allow the TV to fall!

- Do not rest your elbows on, or allow children to hang from the TV. There is a risk that the TV will fall and cause injuries.

## When attaching the TV to the wall, use the optional JVC wall mounting unit!

- Consult a qualified technician.
- See the included manual on mounting procedures.
- JVC assumes no responsibility for damage due to improper mounting.

## Never place anything on the TV!

- Placing liquids, naked flames, cloths, paper, etc. on the TV may cause a fire.



## Make enough room for inserting and removing the power plug!

## Place the TV as close to the outlet as possible!

- The main power supply for this TV is controlled by inserting or removing the power plug.

## Never cut or damage the power cord!

- If the AC plug is not the right shape, or the power cord is not long enough, use an appropriate plug adapter or extension cable. (Consult your retailer.)

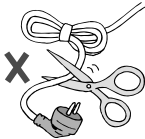

## Never try to repair the TV yourself!

- ➔ If the problem cannot be solved in "Troubleshooting" (P. 33), unplug the power cord and contact your retailer.

## If the TV is damaged or behaving strangely, stop using it at once!

- ➔ Unplug the power cord and contact your retailer.

## Never expose to rain or moisture!

- To prevent fire or electric shock, never allow liquids to enter the unit.



## Never insert objects into the cabinet openings!

- It may cause a fatal electric shock. Take care when children are near.



## Never listen to headphones at high volume!

- It may damage your hearing.

## Unplug the power cord when going out!

- The power buttons on the remote control and the TV unit cannot completely turn off the TV. (Make appropriate arrangements for bedridden people.)

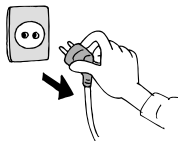

## Never dismantle the rear panel!

- It may cause an electric shock.

## Never obstruct the ventilation holes!

- It may cause overheating or a fire.

## Handle LCD panel with care!

- Use a soft, dry cloth when cleaning.

## Hold the TV so as not to scratch the screen!

- Do not touch the screen when carrying the TV.

## Do not carry the TV on your own!

- In order to prevent accidents, ensure that the TV is carried by two or more people.



■ For more details on installation, usage and safety ➔ Consult your retailer

ENGLISH

IMPORTANT!

PREPARE

USE

SETTINGS

TROUBLE?

# Names of all the parts

ENGLISH

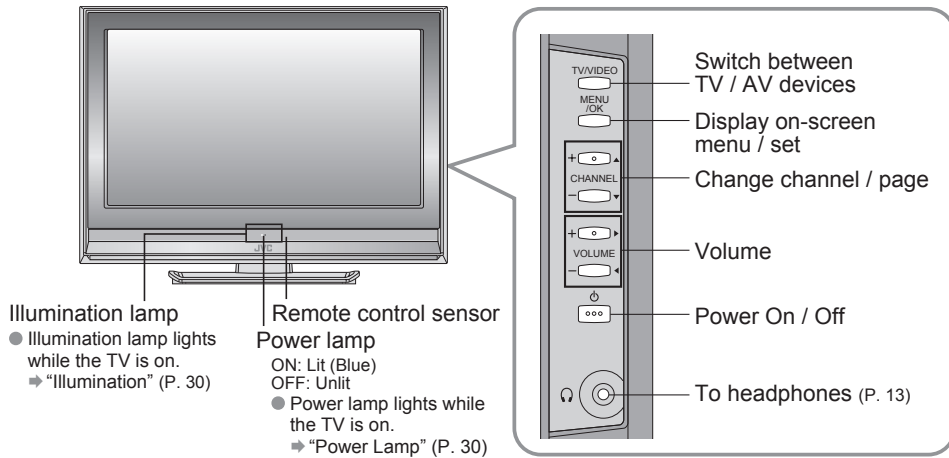

## Remove the terminal cover

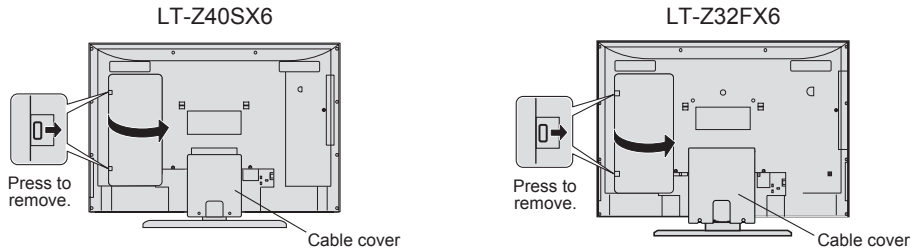

- If the cover cannot be closed due to the cables being in the way → Do not force the cover to close (leave it open).
- Connecting terminals on the back of the TV → Connecting External devices (P. 13)

## Change the direction of TV

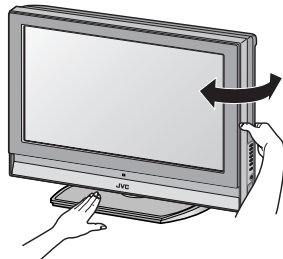

■ The LT-Z40SX6 models differ from illustrations on this page.

## Check accessories

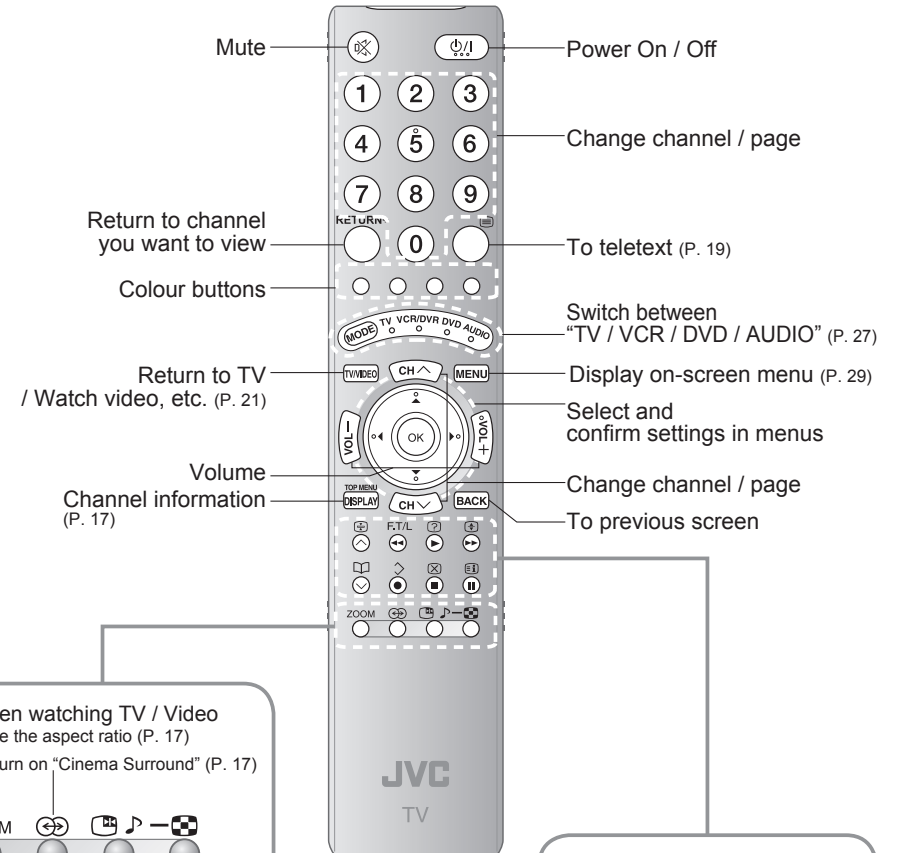
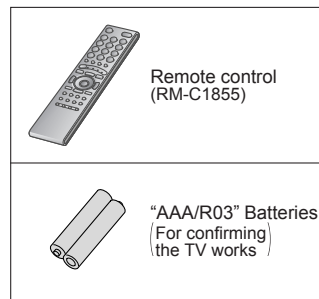

■ When watching TV / Video

Change the aspect ratio (P. 17)

Turn on "Cinema Surround" (P. 17)

ZOOM

Take a snapshot of the screen (P. 23)

View in multi-picture mode (P. 23)

■ Insert the batteries

Use two "AAA/R03" dry cell batteries. Insert the batteries from the ⊖ end, making sure the ⊕ and ⊖ polarities are correct.

■ When viewing teletext (P. 19)

Hold the current page

Bookmark pages

Reveal hidden pages

Enlarge the text

Switch briefly between teletext and TV

To index page

ENGLISH

IMPORTANT!

PREPARE

USE

SETTINGS

TROUBLE?

# Basic connections

Please read the user manuals of each device carefully before setup.  
It is necessary to connect an aerial to watch TV.

■ Connect with other devices → "Connecting external devices" (P. 13)

## Connect the aerial

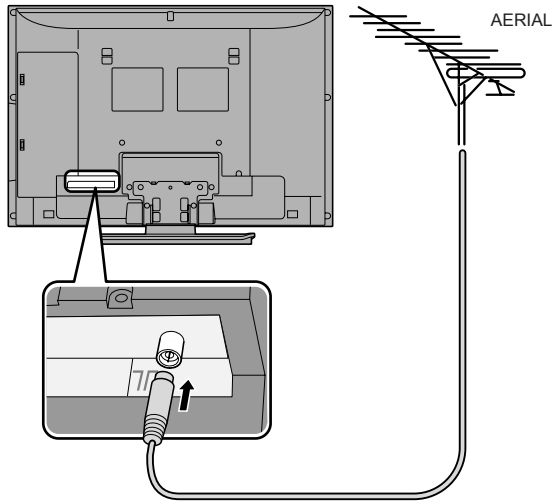

- After all the connections have been made, insert the plug into an AC outlet.

## Connect a VCR / DVD recorder

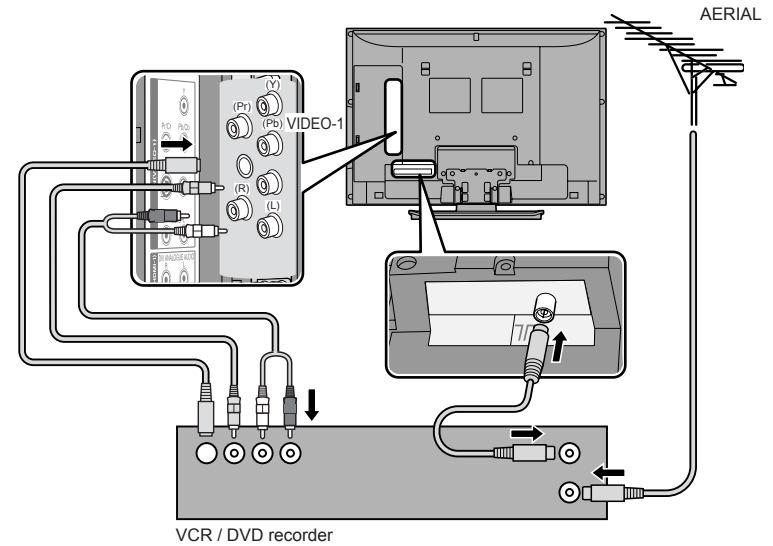

- After all the connections have been made, insert the plug into an AC outlet.
- If both composite and S-VIDEO cables are connected, S-VIDEO will be enable.

## Care when setting

### ■ Power requirements

- Connect the power cord only to a 110-240V, 50/60Hz AC outlet.

### ■ When attaching the TV to the wall, use the optional JVC wall mounting unit

- Consult a qualified technician.
- See the included manual on mounting procedures.
- JVC assumes no responsibility for damage due to improper mounting.
- 200mm × 200mm mount which conforms to VESA standards.

### ■ Installation requirements

- To avoid overheating, ensure the unit has ample room.

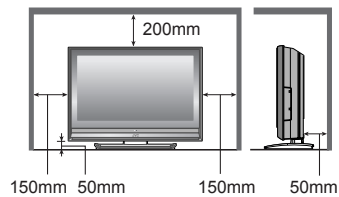

## Tidying the cables

### LT-Z40SX6

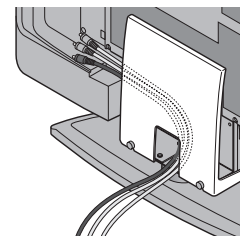

### LT-Z32FX6

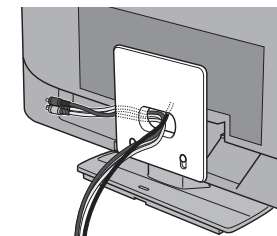

- To remove the cable cover, refer to back of the cover.

# Initial settings

Set the menu language, installation location and automatically register the TV channels. These channels can be edited later in "Editing channels" (P. 11).

**1 Begin**

→

- Shown only when powering on for the first time.
- The power on the unit can also be used.

**2 Select a language**

① select

② set

**3 Select the teletext language group**

select

**4 Automatically register channels**

→

**5 Check what was registered**

**6 Confirm**

■ The remote control doesn't work

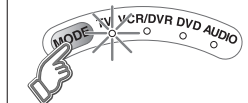

● Confirm the mode is set to "TV".

- For the teletext language group
  - ➔ "Language group for teletext" (P. 37)
- If the characters are unreadable.
  - ➔ "Language group for teletext" (P. 37)

■ To the previous screen ➔ **BACK**

■ Exit ➔ **MENU**

■ If the "JVC" logo does not appear or if you wish to make changes later  
➔ "Language", "Teletext language" and "Auto Program" (P. 30)

# Editing channels

Edit the channels registered with "Auto Program" in "Initial settings" (P. 9).

ENGLISH



When coming from "Initial settings" (P. 9), skip to 4.

- 1 **Display the menu bar**
- 2 **Select "Set Up"**
- 3 **Select "Edit / Manual"**
- 4 **Select a row**
- 5 **Edit**
- 6 **Finish**

■ To the previous screen  
 → **BACK**

■ Exit  
 → **MENU**

**Move a channel's position**

**MOVE**

**Edit a channel name**

**ID**

**Insert a channel**

**INSERT**

**Delete a channel**

**DELETE**

**Register a new channel**

**MANUAL**

① Begin      ② Select a destination      ③ Finish

① Begin      ② Enter a channel name

① Begin      ② Select a "CH / CC"      ③ Enter a number

● "CH/CC" List → (P. 39)

● Receives the broadcast signal.

① Delete (yellow)

① Begin      ② Beginning channel search      ③ Set

● Auto-search begins, and the nearest frequency is imported.  
 → Repeat the previous steps until the desired channel is displayed

■ Adjust

● Channel fine tuning → (yellow) / (blue)

● If the picture or sound is unnatural → select a system

ENGLISH

IMPORTANT!

PREPARE

USE

SETTINGS

TROUBLE?



# Connecting external devices

You can connect many different devices to the rear panel of the TV.  
Please read the user manuals of each device before setting up.  
(Connecting cables are not supplied with this TV.)

ENGLISH

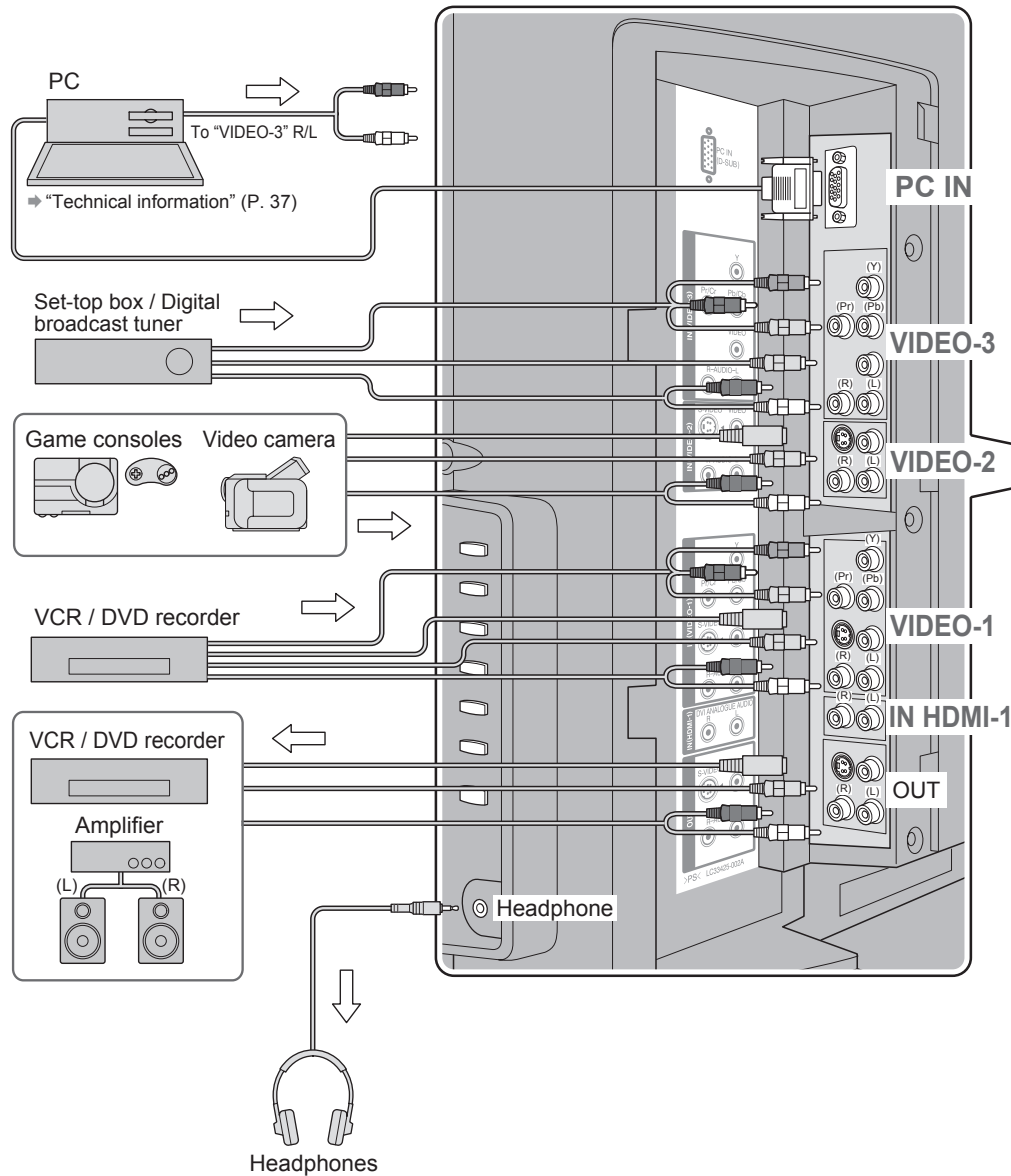

## VCR / DVD / other devices

⇨ : signal direction

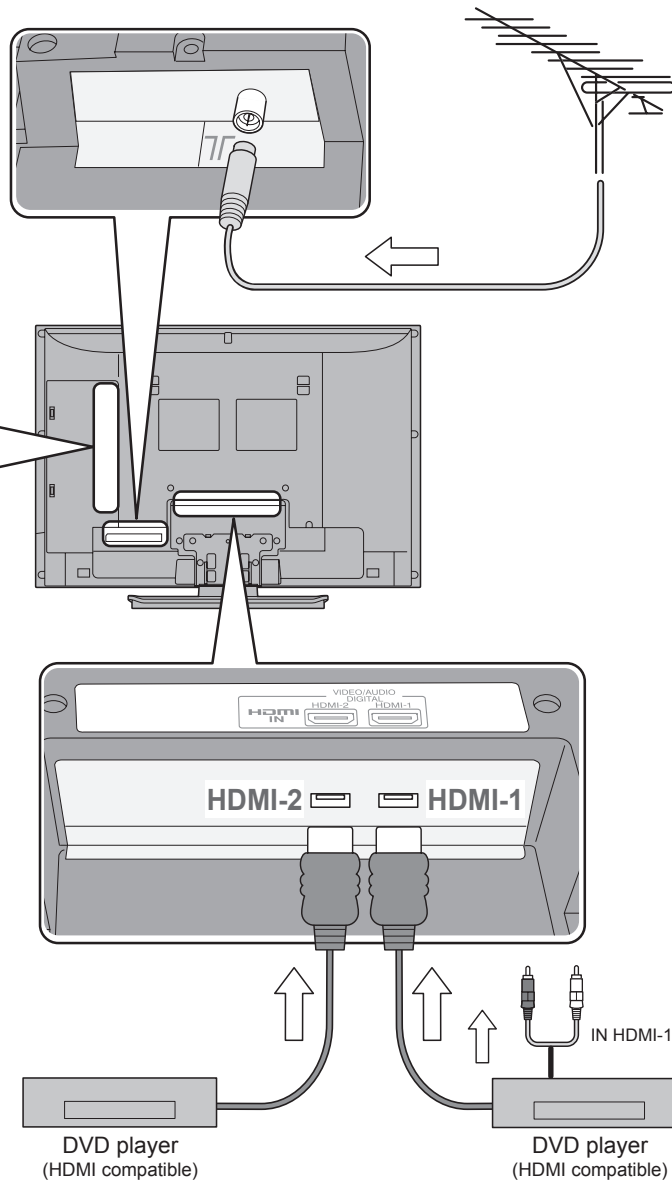

### VIDEO-1 Watching videos

| Output ↑ | Input ↓   |
|----------|---|
|          | · Composite signal / Component signal / S-VIDEO / Sound L / R |

- Use Component signal
  - ➔ "Switch between video and component signal" (P. 22)
- Use S-VIDEO
  - ➔ "Using S-VIDEO" (P. 22)

### VIDEO-2 Watching videos

| Output ↑ | Input ↓                                    |
|----------|--|
|          | · Composite signal / S-VIDEO / Sound L / R |

- Use S-VIDEO
  - ➔ "Using S-VIDEO" (P. 22)

### VIDEO-3 Watching DVDs

| Output ↑ | Input ↓   |
|----------|---|
|          | · Composite signal / Component signal / Sound L / R |

- Use Component signal
  - ➔ "Switch between video and component signal" (P. 22)

### HDMI-1 Connecting HDMI devices

| Output ↑ | Input ↓               |
|----------|-----------------------|
|          | · HDMI signal (P. 38) |

- "HDMI Setting" ➔ (P. 30)
- HDMI-2 input does not support analogue sound.

### OUT

Video and sound signal of a TV channel you are viewing outputs from this terminal

| Output ↓                                   |
|--|
| · Composite signal / S-VIDEO / Sound L / R |

- "Using OUT terminal". ➔ (P. 22)

- Connect a "DVI" device to "HDMI-1" ➔ (P. 38)

ENGLISH

IMPORTANT!

PREPARE

USE

SETTINGS

TROUBLE?

# Enjoying your new TV!

## Watching TV

PAGE  
**17**

- View channel information
- Change the aspect ratio
- Enjoy "Cinema Surround"
- Register your favourite channels

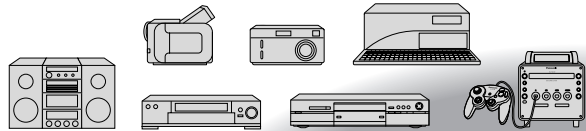
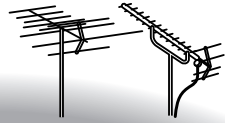
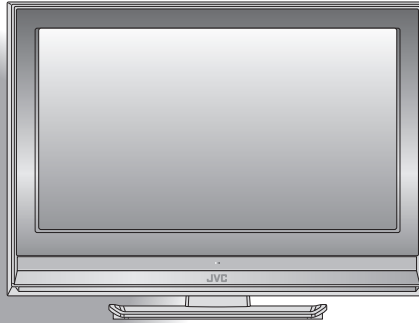
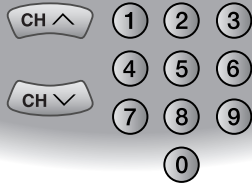

## Watching videos / DVDs

PAGE  
**21**

- Watch high quality video (S-VIDEO)
- Switch between video and component signal
- PC position adjustment

TV/VIDEO

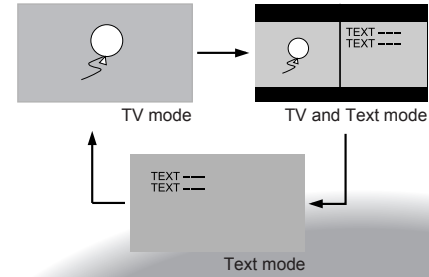

## Viewing teletext

PAGE  
**19**

- Enlarge the text
- To the index page
- Hold the current page
- Switch briefly between teletext and TV
- Bookmark your favourite pages
- Reveal hidden pages

MENU

## Personal preferences

PAGE  
**29**

- Adjust the picture
- Adjust the sound
- Advanced settings (sleep-timer / channel guard, etc.)
- Basic settings (channel settings, etc.)

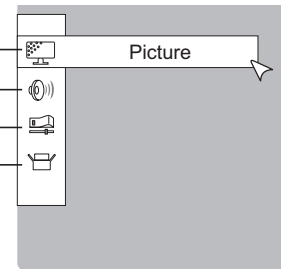

# Watching TV

ENGLISH

**1** Set to "TV"  
MODE TV VCR/DVR DVD AUDIO

**2** Power on  
The blue power lamp on the TV lights

**3** Select a channel  
E.g.  
1 : 0 → 1  
15 : 1 → 5

■ Move up or down a channel  
CH ^ up  
CH v down

■ Switch between mono / stereo / bilingual broadcasting  
→ "Stereo / I-II" ( P. 30)

**Note**  
● To completely turn off the TV, unplug the AC plug.

Volume

## Basic operations using the side buttons

**1** Power on

**2** Change the channel

Volume

### Channel information

DISPLAY

TOP MENU  
DISPLAY

PR List  
01  
02  
03  
04  
05  
06  
07  
08  
09

Channels registered in "Initial settings" will appear here.

Channel information

select

select and view a channel → 1 select, 2 view

### Change the aspect ratio

ZOOM

ZOOM

Zoom  
Auto  
Regular  
Panoramic  
14:9 Zoom  
16:9 Zoom  
16:9 Zoom Subtitle  
Full

16:9 Zoom

Move the picture with ▲ or ▼ while this bar is displayed

- When set to "Auto", the aspect ratio will turn to the ratio obtained from the information the TV received. Without receiving aspect information, it will be the setting in "4:3 Auto Aspect" ( P. 32)
- Not available in 1080i (1125i) / 720p (750p) signals.
- In PC mode, "Regular" and "Full" can be selected.

### Enjoy ambient sound

CINEMA SURROUND

Cinema Surround High

- High : For stereo sound
- Low : For stereo sound (when the sound distorts in "High" mode)
- Mono : For mono sound (emulates a stereo-like sound)
- Off : Turns off "Cinema Surround"

### Emphasize bass sound

MAXXBASS

"MENU" → "Sound" → "MaxxBass"

High

1 select, 2 set

Off Low High level

### Always return to the channel you want to view

RETURN PLUS

Registered as return channel  
While the channel is displayed  
RETURN+ Hold down for 3 seconds → Return Plus Programmed!

Cancel  
While the channel is displayed  
RETURN+ Hold down for 3 seconds → Return Plus Canceled!

Recall the return channel → RETURN+

### Return to the last channel you were viewing

RETURN

RETURN+

Current channel ↔ Last channel

ENGLISH

IMPORTANT!

PREPARE

USE

SETTINGS

TROUBLE?

# Viewing teletext

This TV can display TV broadcasts and teletext on the same channel in two windows.

ENGLISH

**1** When watching TV

**2** Enter a teletext page

1 2 3  
4 5 6  
7 8 9  
0

■ Move up or down a page  
CH ^ up  
CH v down

■ View sub-pages  
to sub-page

TV TEXT  
TEXT TEXT  
TEXT TEXT

01 02 01 02

Bookmark your favourite page

LIST MODE

**1** Display your favourites list F.T/L

(RED) (GREEN) (YELLOW) (BLUE)

**2** Select a coloured button to save your page to

(red) (green) (yellow) (blue)

**3** Enter the number of the page to save

1 2 3  
4 5 6  
7 8 9  
0

**4** Save

■ Recall your favourite page → Press the coloured button as in step 2

**Hold the current page**  
HOLD  
Hold the current page  
Release → Press "OK" again

**Reveal hidden pages**  
REVEAL  
Display hidden information (answers to quizzes, etc.)  
 $1 + 2 =$   
 $2 \times 3 =$  ↔  $1 + 2 = 3$   
 $2 \times 3 = 6$

**Enlarge the text**  
SIZE  
Double the size of the displayed text  
TEXT SIZE ↔ TEXT SIZE

**To the index page**  
INDEX  
Returns to page "100" or a previously designated page

**Switch briefly from teletext to TV**  
CANCEL  
Leave the current page open, while you switch to watch TV  
P233 TEXT TEXT ↔ P233

● Useful when running a page search.

ENGLISH

IMPORTANT!

PREPARE

USE

SETTINGS

TROUBLE?

# Watching videos / DVDs

ENGLISH



**1** Select the video source

TV/VIDEO → AV Select

- 0 01
- 1 Video-1
- 2 Video-2
- 3 Video-3
- 4 HDMI1
- 5 HDMI2
- 6 PC

① select  
② watch

**2** Operate the connected device and play a video

■ Operate JVC recorders and other devices (P. 27)

Select the video source using the side buttons

**1** TV/VIDEO

**2** CHANNEL Select the video source

**3** MENU/OK

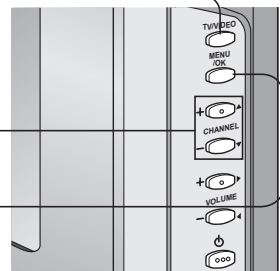

## Switch between video and component signal

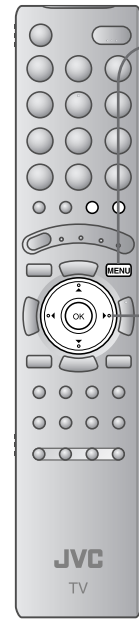

**1** Display the menu bar

MENU

**2** Select "Set Up"

① select  
② next

**3** Select "Video-1 Setting" or "Video-3 Setting"

① select

**4** Change settings

① select  
② set

Video : For normal video signal  
Component : For component video signal

## PC position adjustment



**1** Display the menu bar

MENU

**2** Select "Set Up"

① select  
② next

Select "PC Position"

① select  
② next

● Shown only when "PC" is selected.

**3** Adjust

① adjust  
② set

● Reset position → (blue)

## Using S-VIDEO

- If both composite and S-VIDEO cables are connected, S-VIDEO will be enable.

## Using OUT terminal

- Component and PC signals does not output from this terminal.
- When you are viewing video signal, no signal will output through the S-VIDEO terminal.
- HDMI-1 and HDMI-2 inputs does not output from this terminal.

ENGLISH

IMPORTANT!

PREPARE

USE

SETTINGS

TROUBLE?

# Useful functions

ENGLISH

## Take snapshots of the screen

**FREEZE**

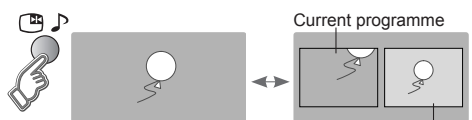

- **Cancel**  
→ Press “**FREEZE**” again, or change the channel
- Not available when the SUB-PICTURE is displayed, or when in PC mode.
- You cannot save or export the snapshot.

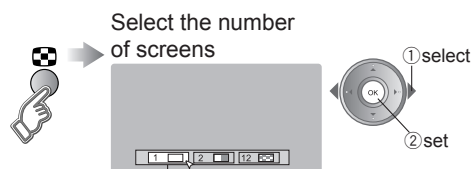

- Selecting “1” returns to normal viewing mode
- Not available in PC mode.

- **Watch in dual-picture mode**  
E.g. You can watch TV and video at the same time.

(For wide aspect ratio signals)



- Switch between the sound sources  
→ **CH**
- Change the channel  
→ (Main) **CH**  
→ (Sub) **CH**

- **Select a channel in 12-screen mode**  
All registered channels are displayed as still images.

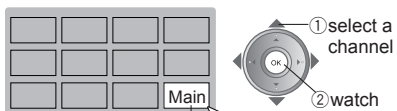

Only the selected frame has a moving picture.

- Move up or down a page → **UP** / **DOWN**
- Not available for HDMI-1 or HDMI-2 input.

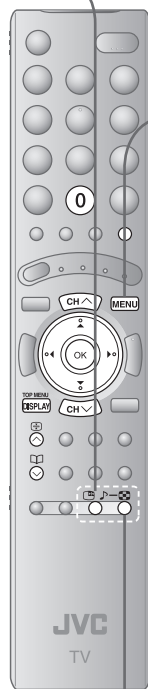

## Set a time for the TV to turn itself off

**SLEEP TIMER**

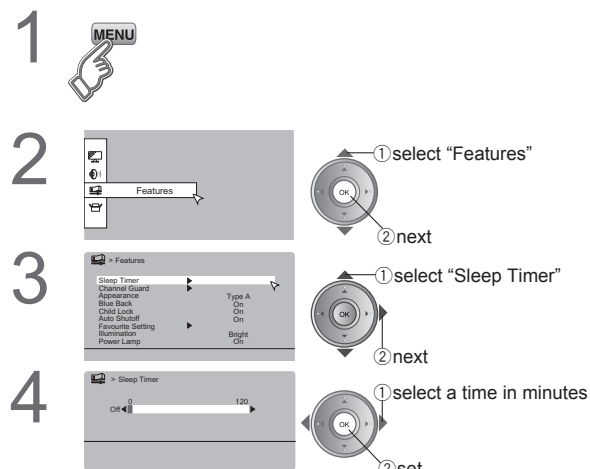

- **Cancel** → Set the time to “0” in step 4
- **Remaining time** → You can confirm the remaining time at step 4, after repeating this process.

- After steps 1 and 2 above

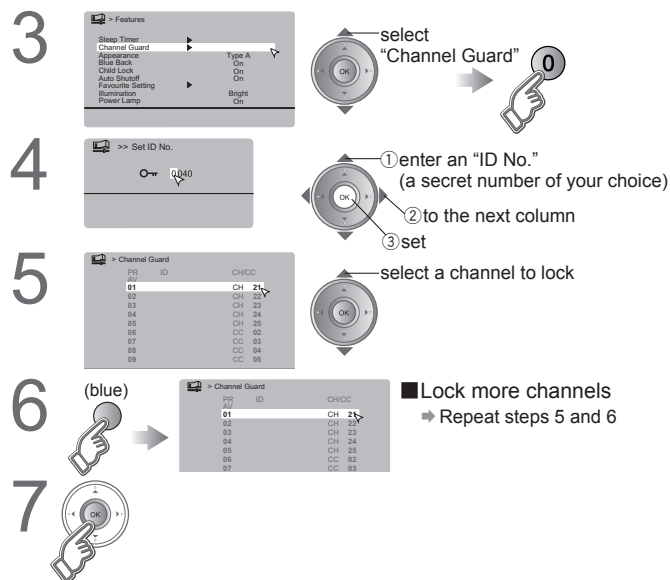

- **Lock more channels**  
→ Repeat steps 5 and 6
- **Release a channel** → Press “**FREEZE**” again in step 6
- **View a locked channel** → Use the numerical buttons to enter the channel number.  
When **LOCK** appears, press “**TOP MENU**” and enter your “ID No.”  
(If you forget your “ID No.”, check it in step 4.)

## Stop children from watching specific channels

**CHANNEL GUARD**

ENGLISH

IMPORTANT!

PREPARE

USE



SETTINGS



TROUBLE?

# Useful functions (continued)



## Register a channel to a button



**FAVOURITE CHANNEL**

**1** While the channel is displayed  
 Hold down for 3 seconds  

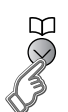
**2** Press the number to register it on  
  
  
 Disappears after a few seconds

### ■ Recall the favourite channel

**1**  

**2** Press the number you registered  
  
  
 ● Customisations (P. 30) to the picture of a favourite channel get saved as well.

### ■ Check your favourite channels

→ Press **TOP MENU** **DISPLAY** and confirm that the channels you have registered have a  beside them

### ■ Delete a favourite channel

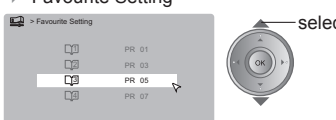
**1** → "MENU" →  → "Features"  
 → "Favourite Setting"  

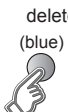
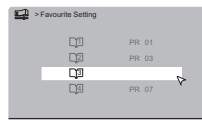
**2** delete (blue)  
  





## Displays a blue screen and mutes the sound when the signal is weak

**BLUE BACK**

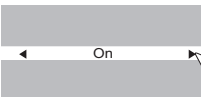
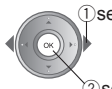
→ "MENU" →  → "Features" → "Blue Back"

   Off : Function is turned off  On : Displays a blue screen

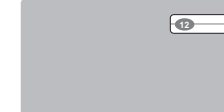

 →   
 When the signal is weak or absent  
 Displays a blue screen and mutes the sound

## Set the power to turn off if no signal is received and no operation is performed

**AUTO SHUTOFF**

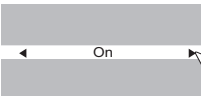
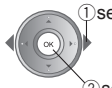
→ "MENU" →  → "Features" → "Auto Shutoff"

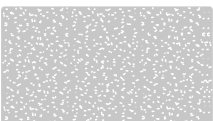
   Off : Function is turned off  On : Set the power to turn off

 →   
 When no signal is received and no operation is performed for about 15 minutes  
 The power turns off

## Prevent sudden increase or decrease of sound when changing channels

**AI VOLUME**

→ "MENU" →  → "Set Up" → "AI Volume"

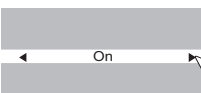
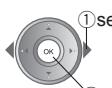
   Off : Function is turned off  On : Set to prevent sudden increase or decrease of sound

# Operate JVC recorders and other devices

The included remote control can be used to operate JVC recorders and other devices.

ENGLISH



- ### 1 Select a device

VCRs  
DVD recorders  
HDD recorders

Home theatre system

MODE TV VCR/DVR DVD AUDIO

TV (P. 6) DVD players

TV → VCR/DVR  
AUDIO ← DVD

  - The indicator lights for 3 seconds each time the remote control is operated.
- ### 2 Turn on the device

Power button
- ### 3 Operate the device

  - Other buttons can be used to operate the TV at any time.

## Try changing the remote control code if you cannot operate a recorder.

■ Code A or 1 (Default)

■ Code C or 3



Press and hold



Press and hold

- Confirm the code for your recorder by checking the manual it came with.
- Some models of JVC devices cannot be operated with this remote control.
- JVC DVD recorders and HDD recorders are set to code "C" or "3" by default.

### Note

- If the battery is removed, the remote control code reverts back to code A or 1.

## Operate the VCR, DVD recorder or HDD recorder

VCR/DVR

■ Operate DVD / HDD recorder menus

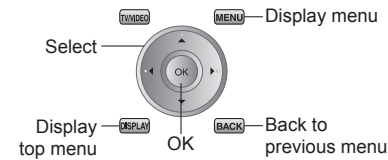

■ Playback / Record etc.

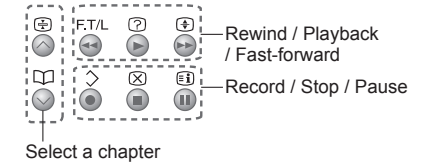

■ Display the subtitle (DVD / HDD recorder mode) → Press "TOP MENU DISPLAY"

## Operate the DVD player

DVD

■ Operate DVD menus

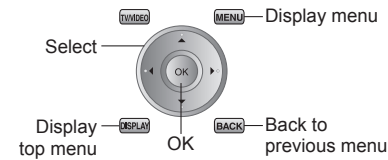

■ Playback etc.

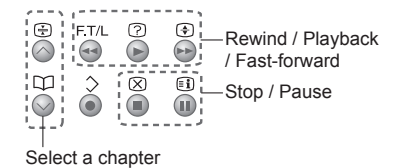

■ Display the subtitle → Press "TOP MENU DISPLAY"

## Operate the home theatre system

AUDIO

■ Operate AUDIO menus

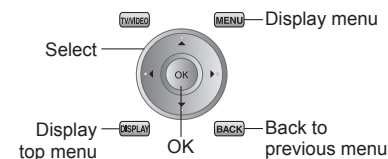

■ Playback etc.

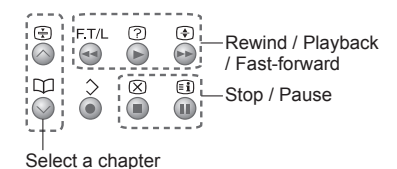

■ Display the subtitle → Press "TOP MENU DISPLAY"

■ Mute → Press "MUTE"

■ Volume → Press "VOL + / VOL -"

■ Select a surround mode → Press "SURROUND"

ENGLISH

IMPORTANT!

PREPARE

USE

SETTINGS

TROUBLE?



# Customising your TV

ENGLISH

**1** Display the menu bar  
 Press the **MENU** button.

**2** Select a menu  
 Press the **select** (OK) button to enter the menu. Press the **next** (right arrow) button to move between menu items.

**3** Select an item  
 Press the **select** (OK) button to enter the sub-menu.

**4** Adjust / Configure  
 Press the **adjust / select** (OK) button to enter the adjustment screen. Press the **set** (right arrow) button to confirm the setting.

■ To the previous screen  
 → **BACK**

■ Exit  
 → **MENU**

● The menu disappears after one minute of inactivity.

■ When adjusting with the sliding-bar  
 Move the slider to the desired position. Press the **adjust / select** (OK) button to enter the adjustment screen. Press the **set** (right arrow) button to confirm the setting.

■ When selecting from presets  
 Press the **select** (OK) button to enter the adjustment screen. Press the **set** (right arrow) button to confirm the setting.

The item will change.

● Some items have a sub-menu.

| Menu            | Item              | Adjustments / Configurations   |
|-----------------|-------------------|--|
| Picture         | Picture Mode      | Picture mode (Bright / Standard / Soft)  |
|                 | Back Light        | Backlight brightness (Darker ⇔ Brighter)   |
|                 | Contrast          | Contrast (Lower ⇔ Higher)  |
|                 | Bright            | Brightness (Darker ⇔ Brighter)   |
|                 | Sharp             | Sharpness (Softer ⇔ Sharper)   |
|                 | Colour            | Colour (Lighter ⇔ Deeper)  |
|                 | Tint              | Tint (Reddish ⇔ Greenish)  |
|                 | White Balance     | Colour temperature (Warm / Mid / Cool)   |
|                 | Features          | Finer picture adjustments (P. 31)  |
|                 | Sound             | Stereo / I · II  |
| Bass            |                   | Low tones (Weaker ⇔ Stronger)  |
| Treble          |                   | High tones (Weaker ⇔ Stronger)   |
| Balance         |                   | Speaker balance (Left Stronger ⇔ Right Stronger)   |
| Cinema Surround |                   | Ambience level (High / Low / Mono / Off)   |
| MaxxBass *1     |                   | Emphasize the bass sound (Off / Low / High)  |
| Features        | Voice Enhancer    | Sound enhancement technology (On / Off)  |
|                 | Sleep Timer       | Timer for turning off the TV (P. 24)   |
|                 | Channel Guard     | Stops children from watching specific channels (P. 24)   |
|                 | Appearance        | Format for displaying the channel number (Type A / Type B)   |
|                 | Blue Back         | Displays a blue screen and mute the sound when the signal is weak or absent (P. 26)                            |
|                 | Child Lock        | Disables the front control buttons of the TV   |
|                 | Auto Shutoff      | Set the power to turn off if no signal is received and no operation is performed for about 15 minutes. (P. 26) |
|                 | Favourite Setting | Clear favourite channel settings (P. 25)   |
| Set Up          | Illumination      | Lights illumination lamp (P. 5) while the TV is on (Bright / Soft / Off)                                       |
|                 | Power Lamp        | Lights power lamp (P. 5) while the TV is on (On / Off)   |
|                 | Auto Program      | Automatically registers channels (P. 10, ③)  |
|                 | Edit / Manual     | Change registered channels or add new ones (P. 11)   |
|                 | Language          | Select a language for on-screen menus (P. 10, ②)   |
|                 | Video-1 Setting   | For use with video players and other devices (P. 22)   |
|                 | Video-3 Setting   | For use with video players and other devices (P. 22)   |
| Set Up          | AI Volume         | Prevent sudden increase or decrease of sound when changing channels (P. 26)                                    |
|                 | Teletext Language | Select a language for Teletext programmes (P. 10, ③)   |
|                 | HDMI Setting      | HDMI-1 : Size (1 / 2 / Auto) HDMI-2 : Size (1 / 2 / Auto) Audio (Digital / Analogue / Auto)                    |
|                 | PC Position       | PC position adjustment (P. 21)   |

● Other settings · Change the aspect ratio → “ZOOM” (P. 17)  
 · Turn on “Cinema Surround” → “CINEMA SURROUND” (P. 17)

\*1 MaxxBass is a registered trademark of Waves Audio Ltd. in the USA, Japan and other countries.

ENGLISH

IMPORTANT!

PREPARE

USE

SETTINGS

TROUBLE?

# Advanced picture adjustment

By default, the TV automatically adjusts itself for the best picture.

ENGLISH



- 1 **Display the menu bar**
- 2 **Select "Picture"**
- 3 **Select "Features"**
- 4 **Select an item**
- 5 **Change settings**
- 6 **Finish**

■ To the previous screen  
 → **BACK**

■ Exit  
 → **MENU**

● The menu disappears after one minute of inactivity.

E.g. "Super DigiPure"

E.g. "Super DigiPure"

|                             |                               |  |  |  |   |  |
|-----------------------------|-------------------------------|--|--|--|---|--|
| <b>Super DigiPure</b>       | For natural-looking outlines  |  | <input type="checkbox"/> Off<br>: Function is turned off   | <input type="checkbox"/> Min<br>: When the picture loses sharpness             | <input type="checkbox"/> Max<br>: When noise appears            | <input type="checkbox"/> Auto<br>: Automatically adjusts |
| <b>Pull Down</b>            | For smooth cinema film        |  | <input type="checkbox"/> Off<br>: Function is turned off   | <input type="checkbox"/> On<br>: Function is always on                         | <input type="checkbox"/> Auto<br>: Automatically adjusts        |  |
| <b>Colour Management</b>    | For natural-looking pictures  |  | <input type="checkbox"/> Off<br>: Function is turned off   | <input type="checkbox"/> On<br>: Maintain a natural colour balance             |   |  |
| <b>Picture Management</b>   | Fix bright / dark pictures    |  | <input type="checkbox"/> Off<br>: Function is turned off   | <input type="checkbox"/> On<br>: Make it easier to view bright / dark pictures |   |  |
| <b>Smart Picture</b>        | Fix brightness of white areas |  | <input type="checkbox"/> Off<br>: Function is turned off   | <input type="checkbox"/> On<br>: Make it easier to view white areas            | ● Not available when "Picture Mode" is set to "Bright" (P. 30). |  |
| <b>MPEG Noise Reduction</b> | To reduce MPEG video noise    |  | <input type="checkbox"/> Off<br>: Function is turned off   | <input type="checkbox"/> On<br>: When noise appears                            |   |  |
| <b>Colour System</b>        | When there is no colour       |  | ① Select the screen to change settings on<br><input type="checkbox"/> Main <input type="checkbox"/> Sub<br>: Main picture    : Sub-picture in MULTI-PICTURE mode (P. 23)   |  |   |  |
|                             |                               |  | ② Select the colour system<br><input type="checkbox"/> PAL <input type="checkbox"/> SECAM <input type="checkbox"/> NTSC 3.58 <input type="checkbox"/> NTSC 4.43 <input type="checkbox"/> Auto<br>● For colour system in your country or region.<br>→ "Colour system in your country or region" (P. 37) |  |   |  |
| <b>4:3 Auto Aspect</b>      | Set a default aspect ratio    |  | Select a default aspect ratio for Auto in "Zoom" (P. 17)<br><input type="checkbox"/> Panoramic <input type="checkbox"/> Regular <input type="checkbox"/> 14:9 Zoom<br>16 : 9    4 : 3    14 : 9  |  |   |  |

ENGLISH

IMPORTANT!

PREPARE

USE

SETTINGS

TROUBLE?

# Troubleshooting

ENGLISH

## Severe noise or snow



- Is the TV connected correctly to the aerial?
- Change the direction of the aerial.
- Is the aerial or its cable damaged?
  - ➔ Consult your retailer

## Patterns, stripes or noise



- Is the aerial receiving interference from high-voltage power lines or wireless transmitters?
  - ➔ Consult your retailer
- Are connected devices too close to the TV?
  - ➔ Insert the minimum distance between the aerial and the cause of interference until no interference

## Ghosting

(Doubling of images)



- Are you receiving interference from signals reflected off mountains or buildings?
  - ➔ Adjust the direction of your aerial, or change to a good-quality directional aerial

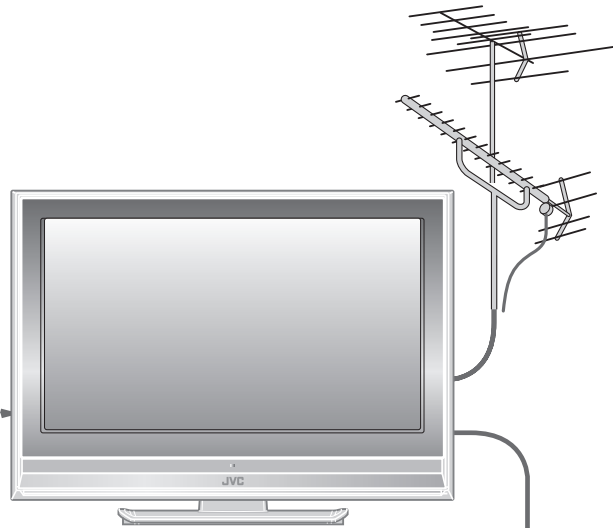

## I can't turn it on!

- Is the power cord connected to the AC outlet correctly?

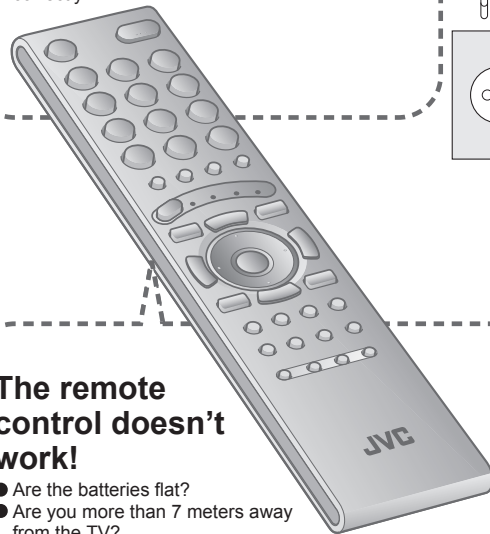

## The remote control doesn't work!

- Are the batteries flat?
- Are you more than 7 meters away from the TV?
- Is the "MODE (TV, VCR/DVR, DVD, AUDIO)" set to "TV"?
- When viewing teletext, the TV menu bar does not appear.
- Depending on the stability of the signal, there may be a time lag when changing channels.

|         | Problem                                       | Actions  | page                 |
|---------|---|--|----------------------|
| Basics  | Remote control stops working                  | ● Unplug TV, several minutes later plug it in again.   | –                    |
|         | Front control buttons does not work           | ● Switch "Child Lock" to "Off".  | 30                   |
| Screen  | Aspect ratio changes unintentionally          | ● Press "ZOOM" to return to your settings.   | 17                   |
|         | PC screen alignment is off                    | ● Adjust the "PC position".  | 21                   |
| Picture | Poor picture quality                          | ● Unnatural colour >>> Adjust "Colour" and "Back Light". Check your "Colour System". If "Auto" is selected, select the specific colour system manually.<br>Noise >>> Set to the following functions.<br>Picture Mode : Standard<br>Super DigiPure : Max<br>Dull picture >>> Set to the following functions.<br>Picture Mode : Bright<br>Super DigiPure : Min | 30<br>32<br>30<br>32 |
|         | Strange picture when using an external device | ● If the top of the image is distorted, check the video signal quality itself.<br>● If movement appears unnatural when receiving a signal from a DVD player, etc. with 625p (progressive-scanning), change the output setting of the external device to 625i (interlace-scanning).   | –<br>–               |
|         | Blue screen appears on the screen             | ● Switch "Blue Back" to "Off".   | 26                   |

ENGLISH

IMPORTANT!

PREPARE

USE

SETTINGS

TROUBLE?

# Troubleshooting (continued)

ENGLISH

|           | Problem   | Actions  | page           |
|-----------|---|--|----------------|
| Sound     | Poor sound  | <ul style="list-style-type: none"> <li>● Adjust the "Bass" and "Treble".</li> <li>● If receiving a poor signal in "Stereo / I-II", switch to "Mono".</li> <li>● Adjust the channel reception using "Manual".</li> </ul>                                  | 30<br>30<br>11 |
|           | Wrong screen size                                 | <ul style="list-style-type: none"> <li>● Switch "Size" in "HDMI Setting" to "1" or "2".</li> </ul>   | 30             |
| HDMI      | No picture, no sound                              | <ul style="list-style-type: none"> <li>● Use the cable marked with HDMI logo. <b>HDMI</b></li> </ul>   | —              |
|           | No sound  | <ul style="list-style-type: none"> <li>● Check if the device is compliant with HDMI.</li> <li>● Switch "Audio" in "HDMI Setting" to "Digital" or "Auto" for HDMI devices, or "Analogue" or "Auto" for DVI devices. (Not available for HDMI-2)</li> </ul> | —<br>30        |
|           | Green and distorted screen                        | <ul style="list-style-type: none"> <li>● Wait a little for the signal to stabilize when switching the signal format for an "HDMI" device.</li> </ul>   | —              |
| Functions | Some functions do not work                        | <ul style="list-style-type: none"> <li>● It is not a malfunction. Some functions (dark background) in the menu do not work depending on the situation.</li> </ul>  | —              |
|           | Some inputs cannot be selected in the sub-picture | <ul style="list-style-type: none"> <li>● "VIDEO-1 (Component signal)", "VIDEO-3 (Component signal)", "HDMI-1", "HDMI-2" inputs and PC mode cannot be selected in the sub-picture.</li> </ul>   | —              |

|              | Problem                                  | Actions  | page |
|--------------|--|--|------|
| Screen       | Black or white dots appear on the screen | <ul style="list-style-type: none"> <li>● LCD panels use fine dots ("pixels") to display images. While more than 99.99% of these pixels function properly, a very small number of pixels may not light, or may light all the time. Please understand that this is not a malfunction.</li> </ul> | —    |
| OUT terminal | No picture, no sound                     | <ul style="list-style-type: none"> <li>● Some inputs does not output from OUT terminal</li> </ul>  | 22   |

ENGLISH

IMPORTANT!

PREPARE

USE

SETTINGS

TROUBLE?

# Technical information

## Language group for teletext

| Group   | Languages  |
|---------|--|
| Group-1 | Turkish, Hungarian, English, German, French, Italian, Spanish, Portuguese, Greek, Swedish, Finnish                         |
| Group-2 | Polish, Serbian, Croatian, Slovenian, Czech, Slovak, Rumanian, Hungarian, German, French, Italian, Swedish, Finnish        |
| Group-3 | Russian, Bulgarian, Lettish, Lithuanian, Estonian, Ukrainian, Serbian, Croatian, Slovenian, Czech, Slovak, English, German |
| Group-4 | Arabic, Czech, Slovak, Hungarian, English, German, French, Italian, Spanish, Portuguese, Swedish, Finnish                  |
| Group-5 | Farsi, Czech, Slovak, Hungarian, English, German, French, Italian, Spanish, Portuguese, Swedish, Finnish                   |

- If the characters are unreadable. → Select different teletext language group.

## Colour system in your country or region

| Area              | Country or Region   | System |
|-------------------|---|--------|
| Asia, Middle East | Bahrain, Kuwait, Oman, Qatar, United Arab Emirates, Yemen, etc. Indonesia, Malaysia, Singapore, Thailand, India, etc. | PAL    |
|                   | China, Vietnam, etc.  |        |
|                   | Hong Kong, etc.   | SECAM  |
|                   | Islamic Republic of Iran, Lebanon, Saudi Arabia, etc.   | NTSC   |
| Europe            | Philippines, Taiwan, Myanmar, etc.  | SECAM  |
|                   | Russia, etc.  | PAL    |
|                   | Czech Republic, Poland, etc.  |        |
|                   | Germany, Holland, Belgium, etc.   |        |
| Oceania           | UK, etc.  | PAL    |
| Africa            | Australia, New Zealand, etc.  | PAL    |
|                   | Republic of South Africa, etc.  | PAL    |
|                   | Nigeria, etc.   | SECAM  |
|                   | Egypt, Morocco, etc.  | SECAM  |

## Sound system in your country or region

| Area                 | Country or Region   | System |
|----------------------|---|--------|
| Asia, Middle East    | Bahrain, Kuwait, Oman, Qatar, United Arab Emirates, Yemen, etc. Indonesia, Malaysia, Singapore, Thailand, India, etc. | B/G    |
|                      | China, Vietnam, etc.  | D/K    |
|                      | Hong Kong, etc.   | I      |
|                      | Islamic Republic of Iran, Lebanon, Saudi Arabia, etc.   | B/G    |
| Europe               | Philippines, Taiwan, Myanmar, etc.  | M      |
|                      | Russia, etc.  | D/K    |
|                      | Czech Republic, Poland, etc.  |        |
|                      | Germany, Holland, Belgium, etc.   |        |
| Oceania              | UK, etc.  | I      |
| Africa               | Australia, New Zealand, etc.  | B/G    |
|                      | Republic of South Africa, etc.  | I      |
|                      | Nigeria, etc.   | B/G    |
| Egypt, Morocco, etc. |   |        |

## Monoaural sound

Use this function when stereo sound or bilingual sound is hard to hear.

- Set "Stereo / I · II" to "MONO" → (P. 30)

## PC Signals that can be displayed

\*Macintosh\* computers are not supported. (Macintosh is a registered trademark of Apple Computer, Inc.)

| Resolution              | 640 x 480 (VGA) | 1024 x 768 (XGA) |
|-------------------------|-----------------|------------------|
| Vertical frequency (Hz) | 60.0            | 60.0             |

- If the signal doesn't appear, check that the vertical frequency on the PC is set to "60Hz".

## Connect "DVI" devices

Connect a "DVI" device to "HDMI-1" using "DVI-HDMI" conversion cable. Connect analogue sound output of the DVI device to L and R terminals in IN HDMI-1.

- Set "Audio" in "HDMI Setting" to "Analogue" or "Auto" → (P. 30)
- HDMI-2 input does not support analogue sound (IN HDMI-1).
- HDMI-2 input does not support DVI devices.

# “CH/CC” List

To use the INSERT function (P. 11), find the “CH/CC” number corresponding to the TV’s Channel number from this table.

US: The US channel numbers are the channel numbers used in the United States, Philippines, etc.  
 CCIR: The CCIR channel numbers are the channel numbers used in the Middle East, Southeast Asia, etc.  
 OIRT: The OIRT channel numbers are the channel numbers used in Eastern Europe, Russia, Vietnam, etc.  
 AUSTRALIA: The AUSTRALIA channel numbers are the channel numbers used in Australia, etc.

| CH    | Channel     |      |      |  | AUSTRALIA |
|-------|-------------|------|------|--|-----------|
|       | US          | CCIR | OIRT |  |           |
| CH 02 | US-02       | E2   | R1   |  | AU-0      |
| CH 03 | US-03       | E3   |      |  | AU-1      |
| CH 04 | US-04       | E4   | R2   |  | AU-2      |
| CH 05 | US-05       | E5   | R6   |  | AU-6      |
| CH 06 | US-06       | E6   | R7   |  | AU-7      |
| CH 07 | US-07       | E7   | R8   |  | AU-8      |
| CH 08 | US-08       | E8   | R9   |  | AU-9      |
| CH 09 | US-09       | E9   |      |  |           |
| CH 10 | US-10       | E10  | R10  |  | AU-10     |
| CH 11 | US-11       | E11  | R11  |  | AU-11     |
| CH 12 | US-12       | E12  | R12  |  |           |
| CH 13 | US-13       |      |      |  |           |
| CH 14 | US-14, W+29 |      |      |  |           |
| CH 15 | US-15, W+30 |      |      |  |           |
| CH 16 | US-16, W+31 |      |      |  |           |
| CH 17 | US-17, W+32 |      |      |  |           |
| CH 18 | US-18, W+33 |      |      |  |           |
| CH 19 | US-19, W+34 |      |      |  |           |
| CH 20 | US-20, W+35 |      |      |  |           |
| CH 21 | US-21, W+36 | E21  |      |  |           |
| CH 22 | US-22, W+37 | E22  |      |  |           |
| CH 23 | US-23, W+38 | E23  |      |  |           |
| CH 24 | US-24, W+39 | E24  |      |  |           |
| CH 25 | US-25, W+40 | E25  |      |  |           |
| CH 26 | US-26, W+41 | E26  |      |  |           |
| CH 27 | US-27, W+42 | E27  |      |  |           |
| CH 28 | US-28, W+43 | E28  |      |  |           |
| CH 29 | US-29, W+44 | E29  |      |  |           |
| CH 30 | US-30, W+45 | E30  |      |  |           |
| CH 31 | US-31, W+46 | E31  |      |  |           |
| CH 32 | US-32, W+47 | E32  |      |  |           |
| CH 33 | US-33, W+48 | E33  |      |  |           |
| CH 34 | US-34, W+49 | E34  |      |  |           |
| CH 35 | US-35, W+50 | E35  |      |  |           |
| CH 36 | US-36, W+51 | E36  |      |  |           |
| CH 37 | US-37, W+52 | E37  |      |  |           |
| CH 38 | US-38, W+53 | E38  |      |  |           |
| CH 39 | US-39, W+54 | E39  |      |  |           |
| CH 40 | US-40, W+55 | E40  |      |  |           |
| CH 41 | US-41, W+56 | E41  |      |  |           |
| CH 42 | US-42, W+57 | E42  |      |  |           |
| CH 43 | US-43, W+58 | E43  |      |  |           |
| CH 44 | US-44, W+59 | E44  |      |  |           |
| CH 45 | US-45, W+60 | E45  |      |  |           |
| CH 46 | US-46, W+61 | E46  |      |  |           |
| CH 47 | US-47, W+62 | E47  |      |  |           |
| CH 48 | US-48, W+63 | E48  |      |  |           |
| CH 49 | US-49, W+64 | E49  |      |  |           |
| CH 50 | US-50, W+65 | E50  |      |  |           |
| CH 51 | US-51, W+66 | E51  |      |  |           |
| CH 52 | US-52, W+67 | E52  |      |  |           |
| CH 53 | US-53, W+68 | E53  |      |  |           |
| CH 54 | US-54, W+69 | E54  |      |  |           |
| CH 55 | US-55, W+70 | E55  |      |  |           |
| CH 56 | US-56, W+71 | E56  |      |  |           |
| CH 57 | US-57, W+72 | E57  |      |  |           |
| CH 58 | US-58, W+73 | E58  |      |  |           |
| CH 59 | US-59, W+74 | E59  |      |  |           |
| CH 60 | US-60, W+75 | E60  |      |  |           |
| CH 61 | US-61, W+76 | E61  |      |  |           |
| CH 62 | US-62, W+77 | E62  |      |  |           |
| CH 63 | US-63, W+78 | E63  |      |  |           |
| CH 64 | US-64, W+79 | E64  |      |  |           |
| CH 65 | US-65, W+80 | E65  |      |  |           |
| CH 66 | US-66, W+81 | E66  |      |  |           |
| CH 67 | US-67, W+82 | E67  |      |  |           |
| CH 68 | US-68, W+83 | E68  |      |  |           |
| CH 69 | US-69, W+84 | E69  |      |  |           |

| CC    | Channel |      |      |  | AUSTRALIA |
|-------|---------|------|------|--|-----------|
|       | US      | CCIR | OIRT |  |           |
| CC 01 |         | S-1  |      |  | AU-5      |
| CC 02 |         | S-2  |      |  |           |
| CC 03 |         | S-3  |      |  |           |
| CC 04 |         | S-4  |      |  |           |
| CC 05 |         | S-5  |      |  |           |
| CC 06 |         | S-6  |      |  | AU-5A     |
| CC 07 |         | S-7  |      |  |           |
| CC 08 |         | S-8  |      |  |           |
| CC 09 |         | S-9  |      |  |           |
| CC 10 |         | S-10 |      |  |           |
| CC 11 |         | S-11 |      |  |           |
| CC 12 |         | S-12 |      |  |           |
| CC 13 |         | S-13 |      |  |           |
| CC 14 | A       | S-14 |      |  |           |
| CC 15 | B       | S-15 |      |  |           |
| CC 16 | C       | S-16 |      |  |           |
| CC 17 | D       | S-17 |      |  |           |
| CC 18 | E       | S-18 |      |  |           |
| CC 19 | F       | S-19 |      |  |           |
| CC 20 | G       | S-20 |      |  |           |
| CC 21 | H       | S-21 |      |  |           |
| CC 22 | I       | S-22 |      |  |           |
| CC 23 | J       | S-23 |      |  |           |
| CC 24 | K       | S-24 |      |  |           |
| CC 25 | L       | S-25 |      |  |           |
| CC 26 | M       | S-26 |      |  |           |
| CC 27 | N       | S-27 |      |  |           |
| CC 28 | O       | S-28 |      |  |           |
| CC 29 | P       | S-29 |      |  |           |
| CC 30 | Q       | S-30 |      |  |           |
| CC 31 | R       | S-31 |      |  |           |
| CC 32 | S       | S-32 |      |  |           |
| CC 33 | T       | S-33 |      |  |           |
| CC 34 | U       | S-34 |      |  |           |
| CC 35 | V       | S-35 |      |  |           |
| CC 36 | W       | S-36 |      |  |           |
| CC 37 | W+1     | S-37 |      |  |           |
| CC 38 | W+2     | S-38 |      |  |           |
| CC 39 | W+3     | S-39 |      |  |           |
| CC 40 | W+4     | S-40 |      |  |           |
| CC 41 | W+5     | S-41 |      |  |           |
| CC 42 | W+6     |      |      |  |           |
| CC 43 | W+7     |      |      |  |           |
| CC 44 | W+8     |      |      |  |           |
| CC 45 | W+9     |      |      |  |           |
| CC 46 | W+10    |      |      |  |           |
| CC 47 | W+11    |      |      |  |           |
| CC 48 | W+12    |      |      |  |           |
| CC 49 | W+13    |      |      |  |           |
| CC 50 | W+14    |      |      |  |           |
| CC 51 | W+15    |      |      |  |           |
| CC 52 | W+16    |      |      |  |           |
| CC 53 | W+17    |      |      |  |           |
| CC 54 | W+18    |      |      |  |           |
| CC 55 | W+19    |      |      |  |           |
| CC 56 | W+20    |      |      |  |           |
| CC 57 | W+21    |      |      |  |           |
| CC 58 | W+22    |      |      |  |           |
| CC 59 | W+23    |      |      |  |           |
| CC 60 | W+24    |      |      |  |           |
| CC 61 | W+25    |      |      |  |           |
| CC 62 | W+26    |      |      |  |           |
| CC 63 | W+27    |      |      |  |           |
| CC 64 | W+28    |      |      |  |           |
| CC 75 |         | X    |      |  |           |
| CC 76 |         | Y    | R3   |  |           |
| CC 77 |         | Z    | R4   |  | AU-3      |
| CC 78 |         | Z+1  | R5   |  |           |
| CC 79 |         | Z+2  |      |  | AU-4      |
| CC 95 | A-5     |      |      |  |           |
| CC 96 | A-4     |      |      |  |           |
| CC 97 | A-3     |      |      |  |           |
| CC 98 | A-2     |      |      |  |           |
| CC 99 | A-1     |      |      |  |           |

# Specifications

| Main unit   |   |   |
|---|---|---|
| Model   | LT-Z40SX6   | LT-Z32FX6                               |
| Broadcasting systems                                | B / G / I / D / K / K1 / M (See “Technical information”, P. 37)   |   |
| Colour systems                                      | PAL, SECAM, NTSC 3.58/4.43MHz   |   |
| Channels and frequencies                            | VHF low channel (VL) = 46.25 to 140.25 MHz<br>VHF high channel (VH) = 147.25 to 423.25 MHz<br>UHF channel (U) = 431.25 to 863.25 MHz<br>· Receives cable channels in mid band (X to Z+2, S1 to S10), super band (S11 to S20) and hyper band (S21 to S41). |   |
| Sound-multiplex systems                             | NICAM (I / B / G / D / K), A2 (B / G / D / K)   |   |
| Teletext systems                                    | FLOF (Fastext), WST (standard system)   |   |
| Power requirements                                  | AC 110 V - 240 V, 50/60Hz   |   |
| Audio output (Rated power output)                   | 10 W + 10 W   |   |
| Speakers  | 6.6 cm round x 2  | 5.0 cm round x 2                        |
| Power consumption [standby]                         | 225 W [0.5 W]   | 121 W [0.4 W]                           |
| Screen size (visible area size measured diagonally) | 102 cm  | 80 cm                                   |
| Dimensions (W x H x D: mm) [without stand]          | 1000 x 733.8 x 324.4 [1000 x 670.5 x 117.3]   | 800 x 591.9 x 244.4 [800 x 545 x 126.5] |
| Weights [without stand]                             | 30.0 kg [24.0 kg]   | 17.0 kg [15.5 kg]                       |
| Accessories   | (See “Check accessories”, P. 5)   |   |

| Terminals / Connectors |               |   |   |       |
|------------------------|---------------|---|---|-------|
| Terminal name          | Terminal type | Signal type (IN)                            | Signal type (OUT)   | Notes |
| Input terminals        | VIDEO-1       | RCA connectors x 6<br>S-VIDEO connector x 1 | Composite video, S-video, Analogue component (576i (625i) / 480i (525i), Progressive : 576p (625p) / 480p (525p), HD : 1080i (1125i), 720p (750p))<br>AUDIO L / R |       |
|                        | VIDEO-2       | RCA connectors x 3<br>S-VIDEO connector x 1 | Composite video, S-video, AUDIO L / R   |       |
|                        | VIDEO-3       | RCA connectors x 6                          | Composite video, Analogue component (576i (625i) / 480i (525i), Progressive : 576p (625p) / 480p (525p), HD : 1080i (1125i), 720p (750p))<br>AUDIO L / R          |       |
|                        | HDMI-1        | HDMI connector x 1                          | HDMI (576i (625i) / 480i (525i) / 576p (625p) / 480p (525p), 1080i (1125i), 720p (750p))  |       |
|                        | HDMI-2        |   |   |       |
|                        | IN HDMI-1     | RCA connectors x 2                          | AUDIO L / R   |       |
|                        | PC INPUT      | D-SUB (15 pins) x 1                         | Analogue PC signal (P. 38)  |       |
| Output terminals       | MONITOR OUT   | RCA connectors x 3<br>S-VIDEO connector x 1 | Composite video, S-video, Audio L / R   |       |
|                        | Headphone     | Stereo mini-jack x 1 (3.5 mm in diameter)   | Headphone output  |       |

● We may change the design and specifications without notice.